

1 Assembler les jonctions.
Assemble the junctions

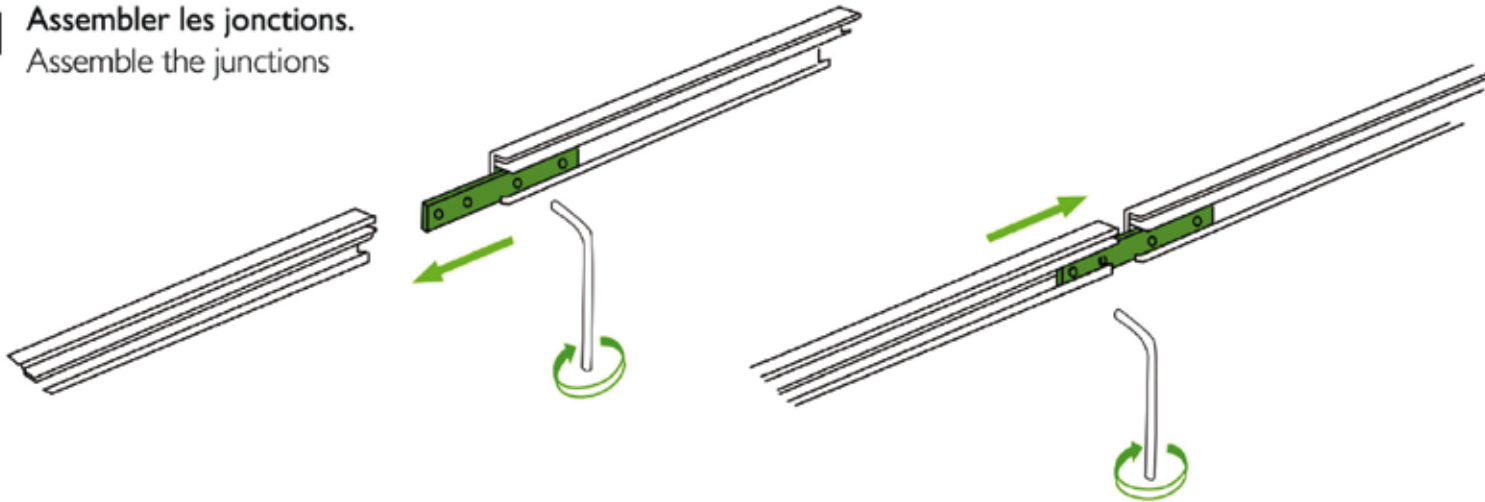

2 Monter les équerres.
Mount the brackets

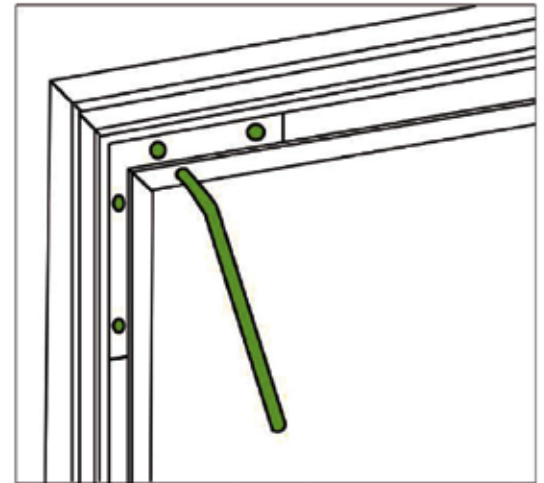
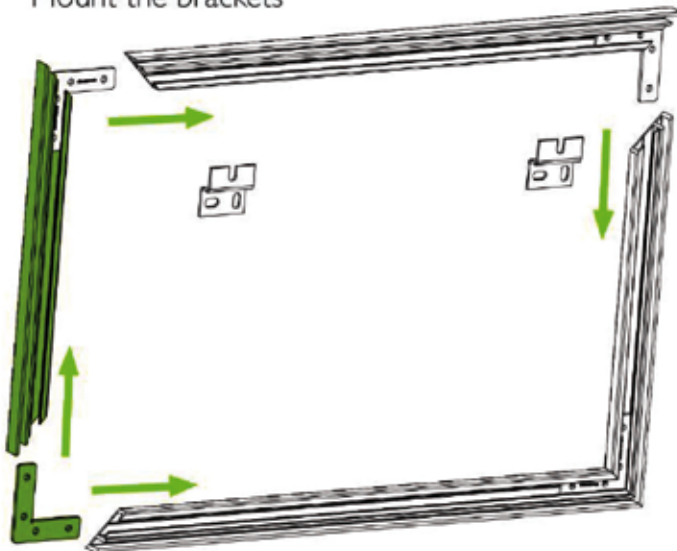

Terminer le montage d'un côté du cadre en fixant les 2 équerres.
Finish the assembly of the frame on one side by fixing the 2 brackets.

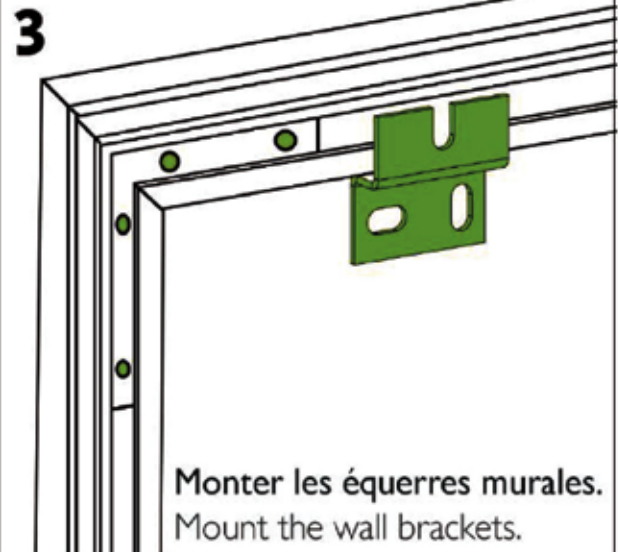
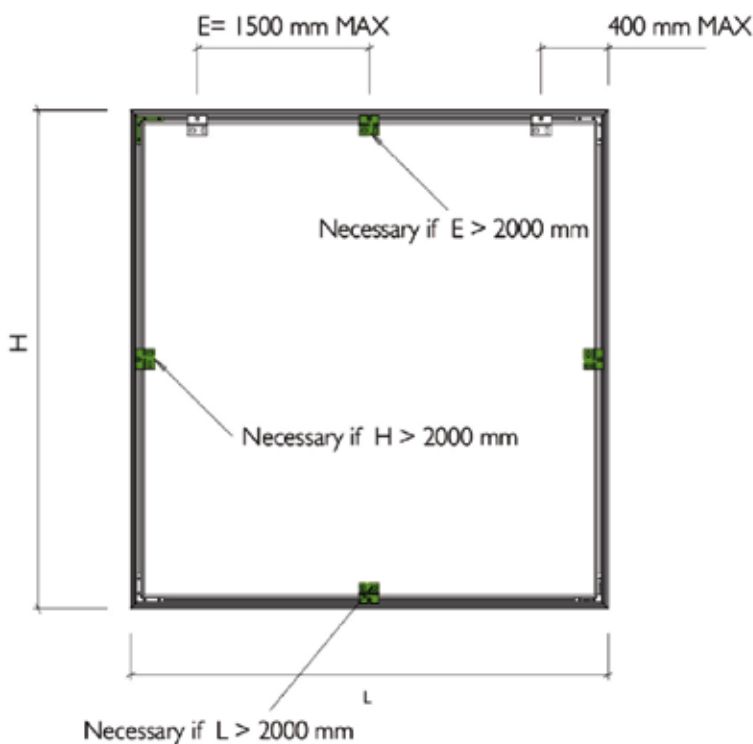

Les chevilles ne sont pas fournies, choisissez des chevilles adaptées à votre mur.
The wall screws are not included. Choose the screw best adapted to the wall type.

Single sided



ACP008



25cm

Placer les pieds sous le caisson, visser la vis sur chaque pied avec une clé hexagonale.

Place the feet under the box, and fasten one screw on each foot with the hex key.



Double sided



ACP009

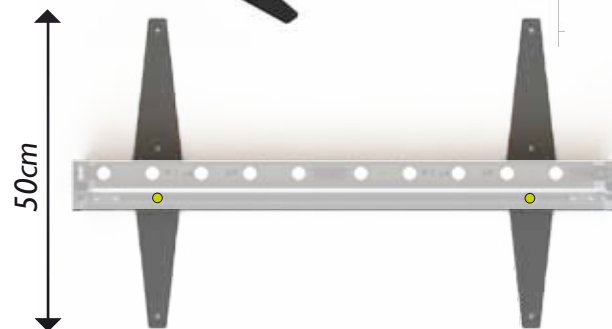

50cm

Placer les pieds sous le caisson, visser les 2 vis sur chaque pied avec une clé hexagonale.

Place the feet under the box, and fasten 2 screws on each foot with the hex key.



NOTICE DE MONTAGE - SET UP INSTRUCTIONS

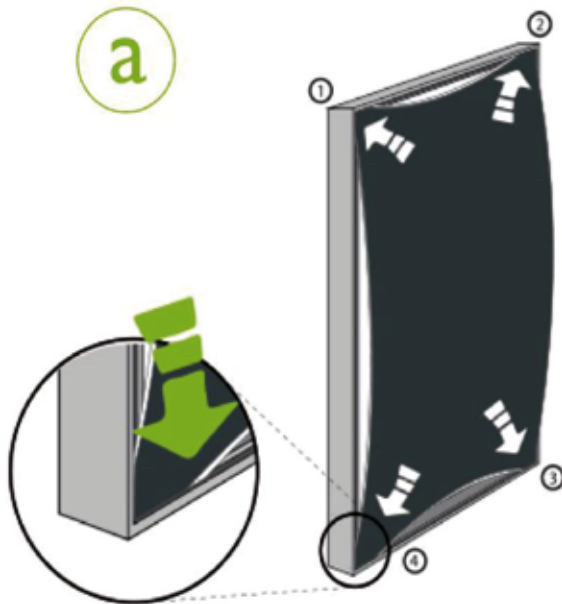
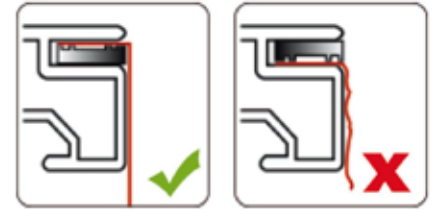

Commencez par les 4 angles

Position the graphic in the 4 corners of the frame by pushing the silicon edging into the groove

Insérer le joint au milieu du cadre

Position the graphic edging in the middle of each side of the frame

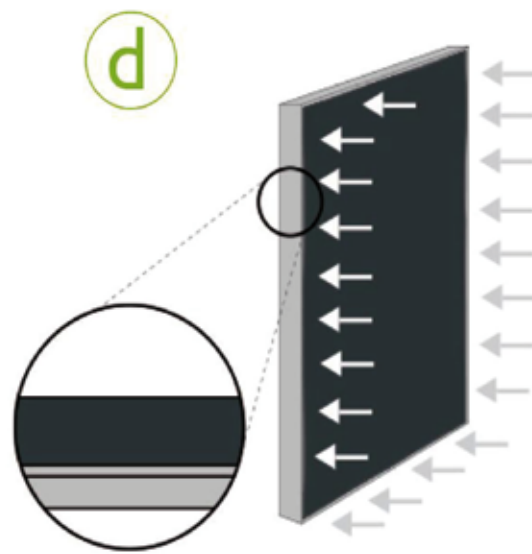
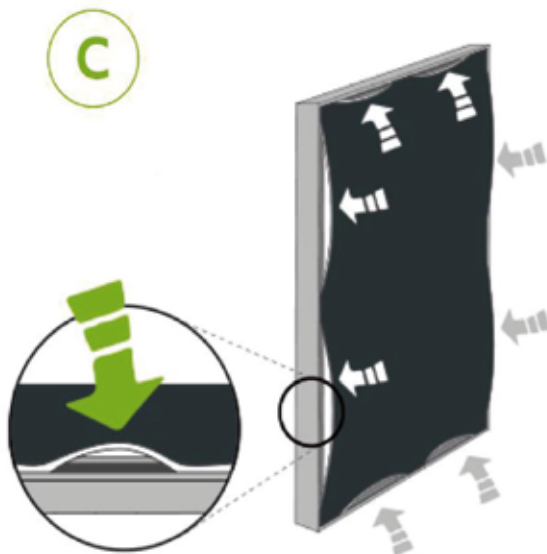
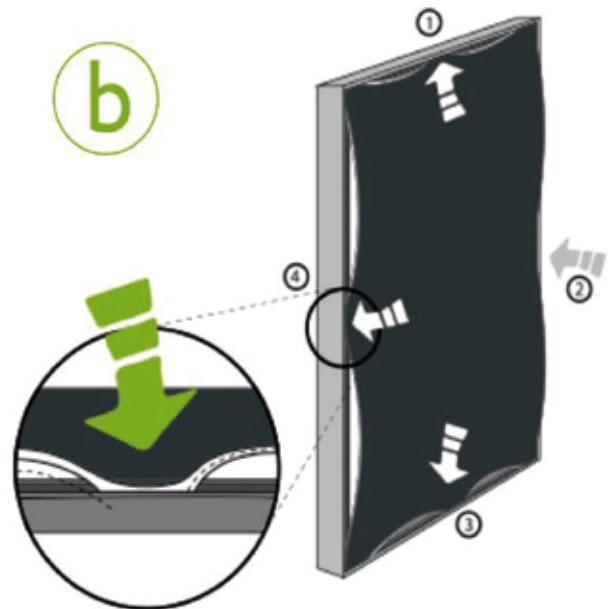

Puis se diriger vers les extrêmités par petits appuis.
Ne pas faire glisser les doigts sur le visuel.

Work outwards towards the corners while continuing to press downwards on to the edging.
To avoid stretching, creasing at the edges and dirtying of the graphic, do not wipe your hands across image.